

## Installation Guide

# Danfoss Link™ FT

## Floor Thermostat



---

## Table of Contents

---

<b>1</b>	<b>Introduction . . . . .</b>	<b>2</b>
<b>2</b>	<b>Placement of Danfoss Link™ FT . . . . .</b>	<b>4</b>
	2.1 Operation mode . . . . .	4
	2.2 Sensor combination. . . . .	4
<b>3</b>	<b>Installation . . . . .</b>	<b>6</b>
	3.1 Configuration . . . . .	7
<b>4</b>	<b>Factory reset . . . . .</b>	<b>7</b>
<b>5</b>	<b>Technical specifications . . . . .</b>	<b>7</b>
<b>6</b>	<b>Warranty. . . . .</b>	<b>9</b>
<b>7</b>	<b>Disposal instructions. . . . .</b>	<b>9</b>

## 1 Introduction

---

The Danfoss Link™ FT (Floor Thermostat) is a device for switching the heating element ON/OFF.

In connection with a floor sensor it can also measure the temperature in the floor (FTS).

Secondly you have the possibility to use the Danfoss Link™ FT as a on and off switch to other equipments manually or by schedule.

## Installation scenario:

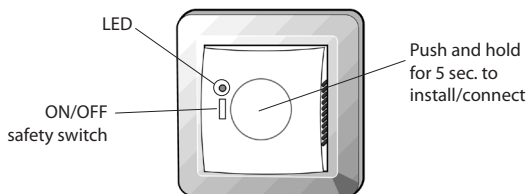
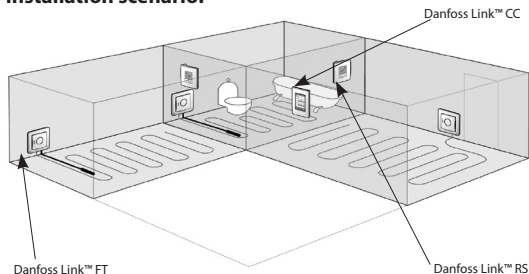

## 2 Placement of Danfoss Link™ FT

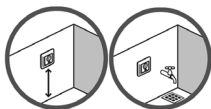

Installation and placement must be according to local building regulations.

### 2.1 Operation mode

Danfoss Link™ FT supports two types of operation modes.

1. Heating regulation
1. On/OFF switching

When used in heating regulation mode you have to consider the following advices for controlling the heating.

When used as simple ON/OFF mode do not connect floor sensor.

### 2.2 Sensor combination

When installing the Danfoss Link™ FT you need to consider the type of heating and thus which sensors should be used. There are three options:

1. **Comfort heating:** Constant temperature on the floor in bathrooms and other rooms where a comfortable warm surface is required. Install the Floor sensor and choose Floor regulation for the room when doing the configuration.
2. **Total heating:** Control of room temperature in living rooms etc. Install the floor sensor and a Danfoss Link™ RS. Choose Combined regulation when doing the configuration on the Danfoss Link™ CC.
3. **No floor sensor:** A floor sensor is not present, and cannot be installed. You must install a Danfoss Link™ RS. Choose Room regulation.

Be aware that temperature control is less accurate without the floor sensor and that all Danfoss Link™ FTs in a room need to have the same sensor configuration.

Danfoss recommends always installing a floor sensor.

*Do not install floor heating system without a floor sensor when the heating element is installed on or beneath wooden surfaces and other surfaces sensitive to temperature!*

### 3 Installation

1. To remove the front cover, gently press the release tabs under the bottom of the thermostat with a screwdriver. Then remove the front.

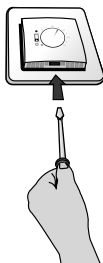

2. Connect the thermostat according to the connection diagram.

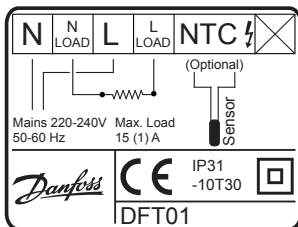

### 3.1 Configuration

---

See Step-by-Step guide in Danfoss Link™ CC instruction manual.

Green LED ON	Standby
Red LED ON	Heating
Green LED fast flash	Inclusion or link test
Red LED short flash	Inclusion not OK, goes to not included. Linktest not OK, goes to missing link
RED LED slow flash	Sensor failure

## 4 Factory reset

---

Turn off power on the safety switch on the front. Hold the install button in while pushing ON the safety switch and keep the install button pressed until the LED gives a red flash (approx. 5 sec.)

## 5 Technical specifications

---

Operation voltage	220-240 V~ 50/60 Hz~
Standby power consumption	Max. 1 W

Relay: <ul style="list-style-type: none"> <li>• Resistive load</li> <li>• Inductive load</li> </ul>	230 V ~ 15 A / 3450 W $\cos \phi = 0.3$ Max. 1 A
Sensing unit	NTC 15 kOhm at 25°C
Sensing values: <ul style="list-style-type: none"> <li>• 0°C</li> <li>• 20°C</li> <li>• 50°C</li> </ul>	42 kOhm 18 kOhm 6 kOhm
Regulation	PWM
Ambient temperature	-10° to +30°C
Sensor failure monitoring	The thermostat has a built-in monitoring circuit, which will switch off the heating if the sensor is disconnected or short-circuited
Transmission frequency	868.42 MHz
Transmission range in normal buildings	Up to 30 m
Transmission power	Max. 1 mW
IP class	31
Dimensions	85 mm × 85 mm × 21 mm



## 6 Warranty

---



## 7 Disposal instructions

---

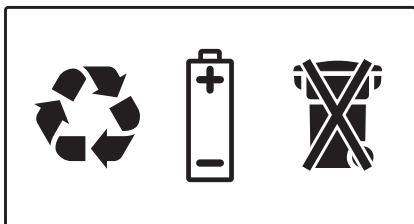



Danfoss A/S  
Electric Heating Systems  
Ulvehavevej 61  
7100 Vejle  
Denmark  
Phone: +45 7488 8500  
Fax: +45 7488 8501  
E-mail: [EH@danfoss.com](mailto:EH@danfoss.com)  
<http://electricheating.danfoss.com>

Danfoss can accept no responsibility for possible errors in catalogues, brochures and other printed material. Danfoss reserves the right to alter its products without notice. This also applies to products already on order provided that such alterations can be made without subsequential changes being necessary in specifications already agreed. All trademarks in this material are property of the respective companies. DEVI and the DEVI logo-type are trademarks of Danfoss A/S. All rights reserved

# Danfoss Link™ FT, ELKO JUSSI

088L1905 EN

Floor Thermostat  
220-240V~  
50-60Hz  
+5°C to +45°C  
15A/3450W@230V~  
IP 31

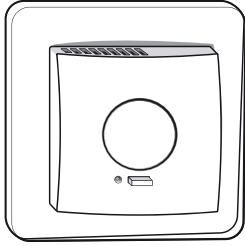

Product documentation



Designed in Denmark for Danfoss A/S

